





-  = CARPETED AREA
-  = EXTERIOR RECEPTACLE
-  = RECEPTACLE WITH USB
-  = EXTERIOR HOSE BIBB
-  = CABLE T.V. OUTLET
W/ ELECTRICAL OUTLET





AMERICAN & HERITAGE FLOOR PLAN

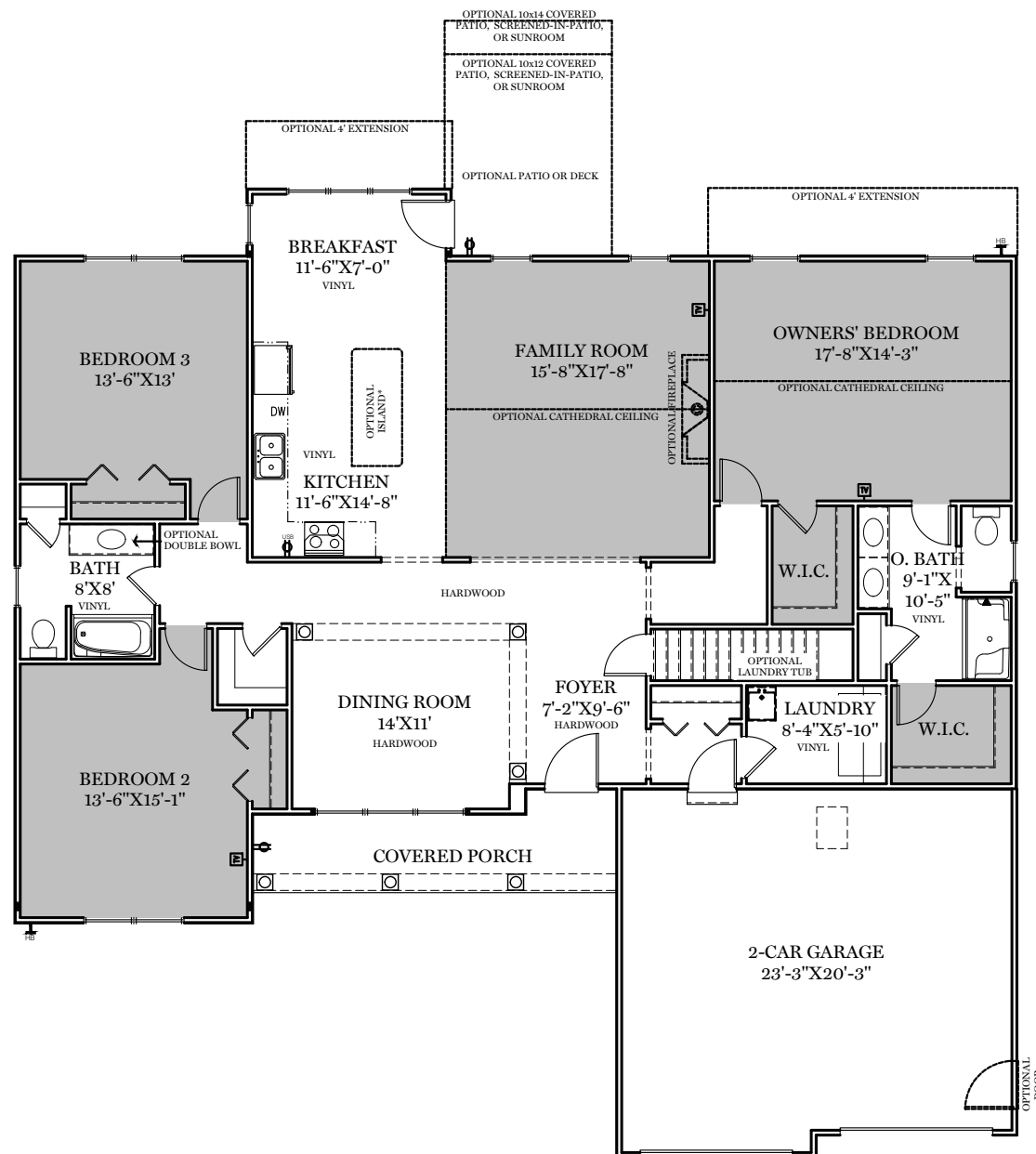
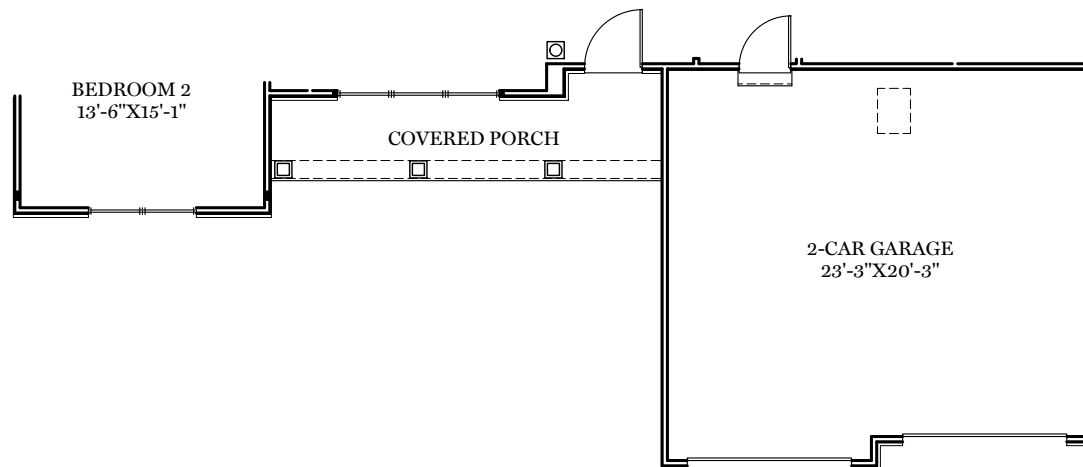
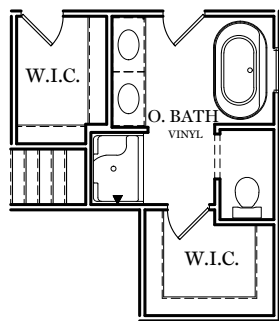

OPTIONAL RETREAT BATH

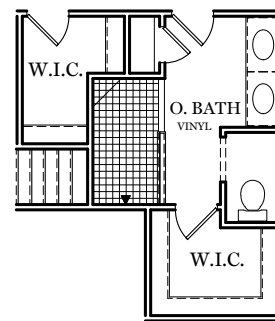

OPTIONAL LUXURY BATH

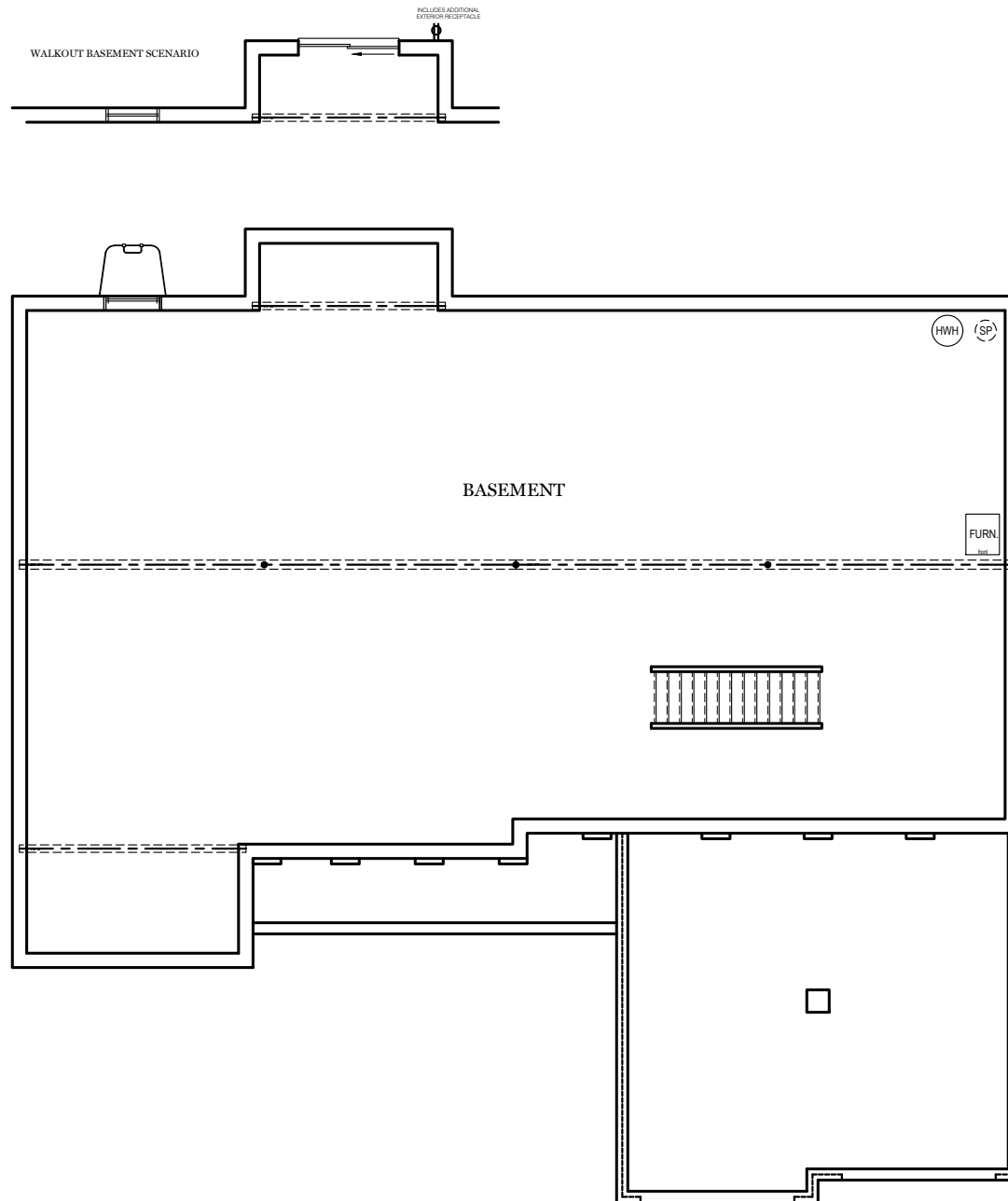

TRADITIONAL** FLOOR PLAN SHOWN

Foundation

BROOKFIELD

** TRADITIONAL FLOOR
PLAN ONLY AVAILABLE IN
SELECT COMMUNITIES

E.G.S. RESERVES THE RIGHT TO
RELOCATE MECHANICALS AS REQ.
BY SITE CONDITIONS

ALL IMAGES ARE FOR ARTISTIC
PURPOSES ONLY AND MAY CONTAIN
ADDITIONAL FEATURES OR DESIGN
OPTIONS NOT AVAILABLE ON ALL
HOME PLANS AND IN ALL
NEIGHBORHOODS. ROOM SIZE
DIMENSIONS AND SQUARE FOOTAGES
ARE APPROXIMATE. CONTACT SALES
AGENT FOR MORE INFORMATION.
TERMS AND CONDITIONS APPLY.
[HTTPS://EGSTOLTZFUSHOMES.COM/
TERMS-AND-CONDITIONS/](https://EGSTOLTZFUSHOMES.COM/TERMS-AND-CONDITIONS/)

PDF LAST UPDATED 7/12/2022

■ = CARPETED AREA

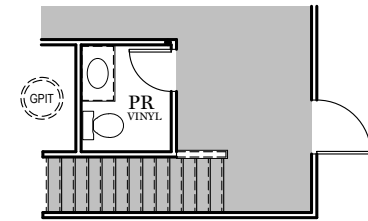
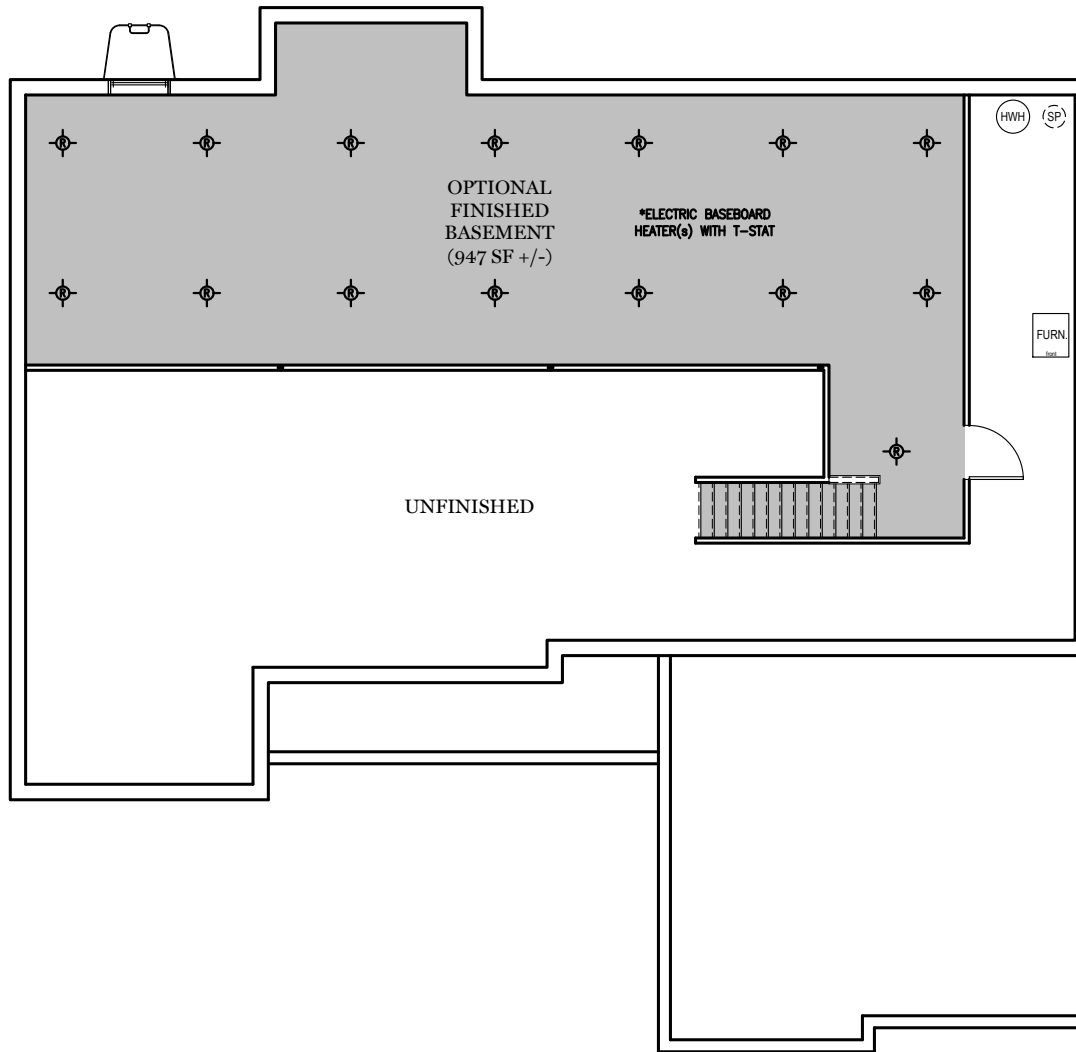

OPTIONAL FINISHED
POWDER ROOM (+ 32 SF)

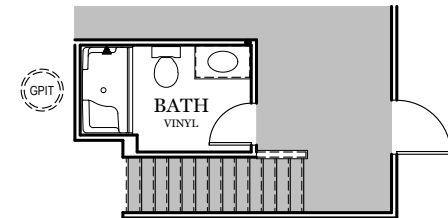

OPTIONAL FINISHED
BATHROOM (+ 56 SF)



TRADITIONAL ELEVATION**



CLASSIC ELEVATION

Elevations

BROOKFIELD



AMERICAN ELEVATION



HERITAGE ELEVATION

Elevations

BROOKFIELD