





-  = CARPETED AREA
-  = EXTERIOR RECEPTACLE
-  = EXTERIOR HOSE BIBB
-  = FLUSH MOUNT RECESSED-STYLE LIGHT
-  = CEILING LIGHT



ALL IMAGES ARE FOR ARTISTIC PURPOSES ONLY AND MAY CONTAIN ADDITIONAL FEATURES OR DESIGN OPTIONS NOT AVAILABLE ON ALL HOME PLANS AND IN ALL NEIGHBORHOODS. ROOM SIZE DIMENSIONS AND SQUARE FOOTAGES ARE APPROXIMATE. CONTACT SALES AGENT FOR MORE INFORMATION. TERMS AND CONDITIONS APPLY. [HTTPS://EGStoltzfusHomes.com/terms-and-conditions/](https://EGStoltzfusHomes.com/terms-and-conditions/)

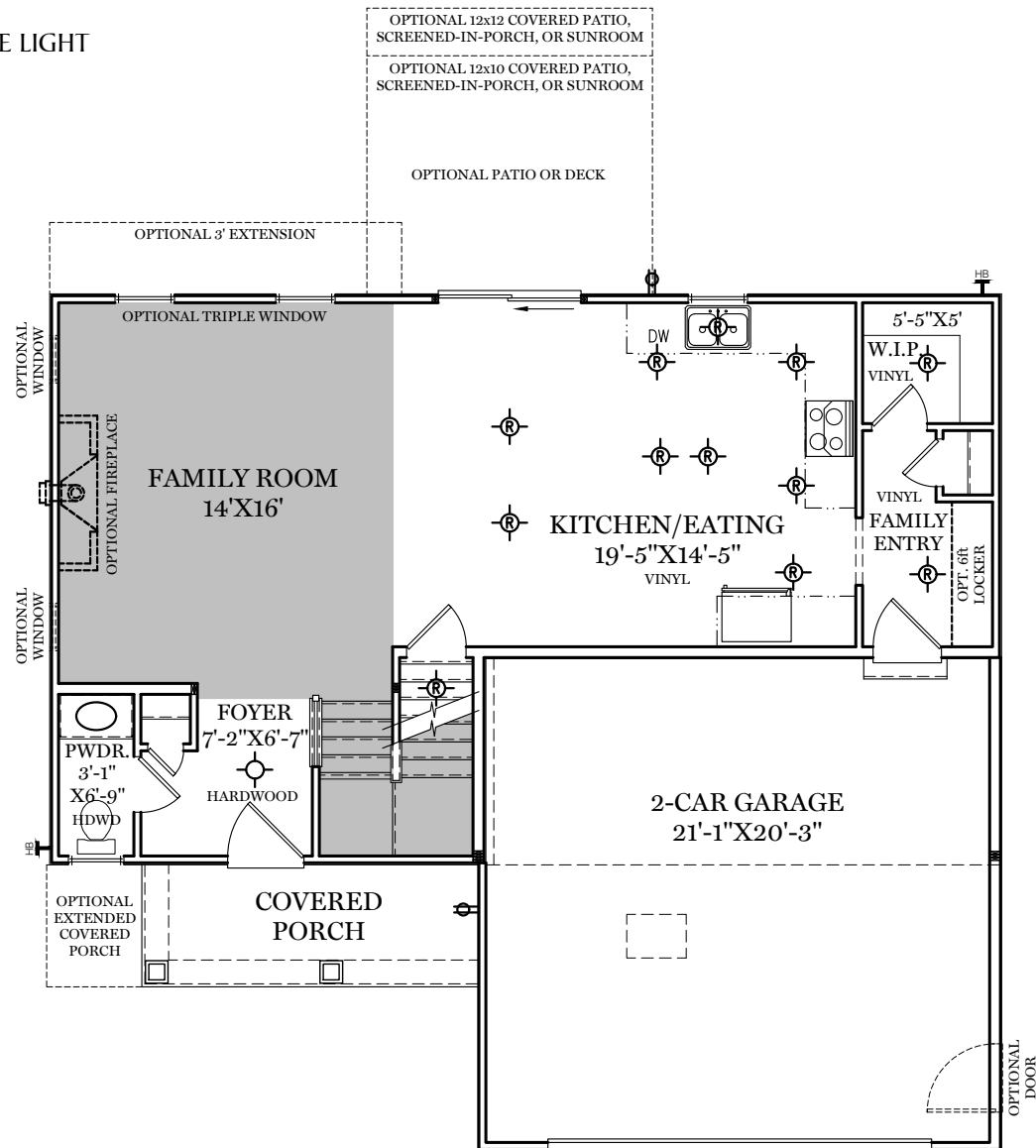
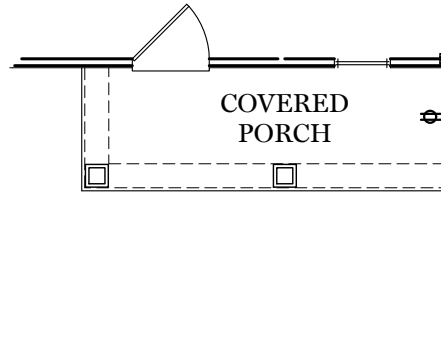

CLASSIC FLOOR PLAN

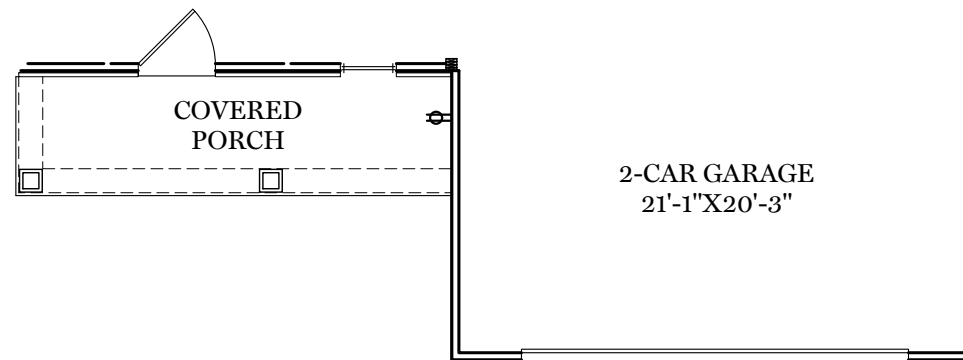

HERITAGE FLOOR PLAN

1st Floor Plan

"ROCKFORD"

- = CARPETED AREA
 ⊗ = FLUSH MOUNT RECESSED-STYLE LIGHT

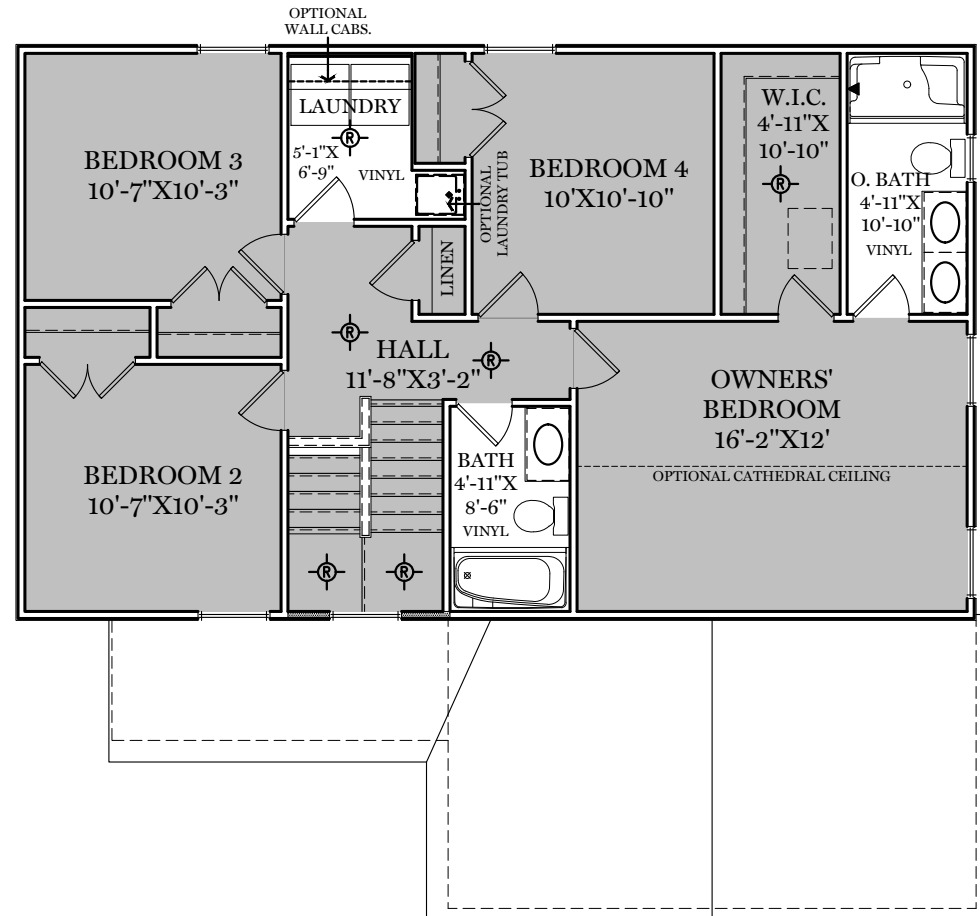

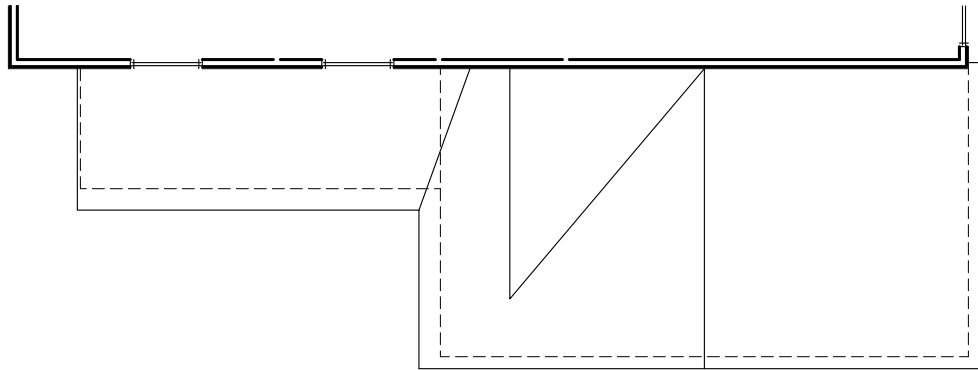

CLASSIC FLOOR PLAN

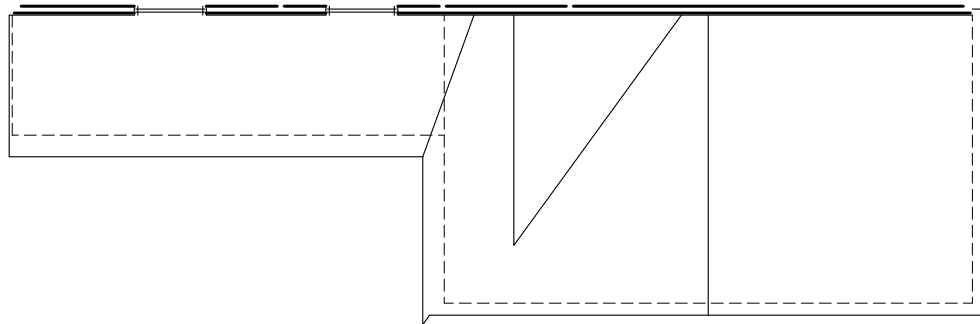

HERITAGE FLOOR PLAN

2nd Floor Plan

"ROCKFORD"



EGStoltzfus
BUILDING ONE STORY AT A TIME

ALL IMAGES ARE FOR ARTISTIC
PURPOSES ONLY AND MAY CONTAIN
ADDITIONAL FEATURES OR DESIGN
OPTIONS NOT AVAILABLE ON ALL
HOME PLANS AND IN ALL
NEIGHBORHOODS. ROOM SIZE
DIMENSIONS AND SQUARE FOOTAGES
ARE APPROXIMATE. CONTACT SALES
AGENT FOR MORE INFORMATION.
TERMS AND CONDITIONS APPLY.
[HTTPS://EGSTOLTZFUSHOMES.COM/
TERMS-AND-CONDITIONS/](https://egstoltzfushomes.com/terms-and-conditions/)

PDF LAST UPDATED 8/23/2023

INCLUDES ADDITIONAL
EXTERIOR RECEPTACLE

The floor plan shows a large rectangular room labeled "BASEMENT". On the left side, there is a staircase with a railing. To the right of the staircase, there is a small room with a door labeled "SP". Further to the right, there is a water heater labeled "HWH" and a furnace labeled "FURN.". The furnace is located in a small room that is part of a larger area on the right side of the plan. The overall layout includes a main basement area, a staircase, and several utility rooms.

ALL IMAGES ARE FOR ARTISTIC
PURPOSES ONLY AND MAY CONTAIN
ADDITIONAL FEATURES OR DESIGN
OPTIONS NOT AVAILABLE ON ALL
HOME PLANS AND IN ALL
NEIGHBORHOODS. ROOM SIZE
DIMENSIONS AND SQUARE FOOTAGES
ARE APPROXIMATE. CONTACT SALES
AGENT FOR MORE INFORMATION.
TERMS AND CONDITIONS APPLY.
[HTTPS://EGSTOLTZFUSHOMES.COM/
TERMS-AND-CONDITIONS/](https://EGSTOLTZFUSHOMES.COM/TERMS-AND-CONDITIONS/)

** TRADITIONAL FLOOR
PLAN ONLY AVAILABLE IN
SELECT COMMUNITIES

PDF LAST UPDATED 8/23/2023



Foundation
"ROCKFORD"

■ = CARPETED AREA

⊗ = FLUSH MOUNT RECESSED-STYLE LIGHT

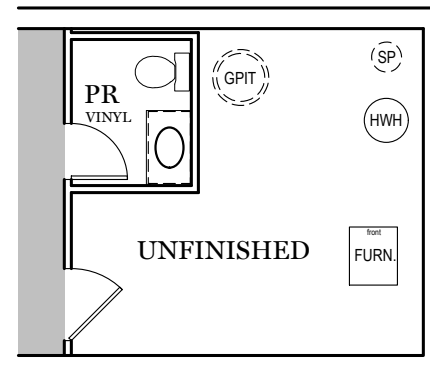
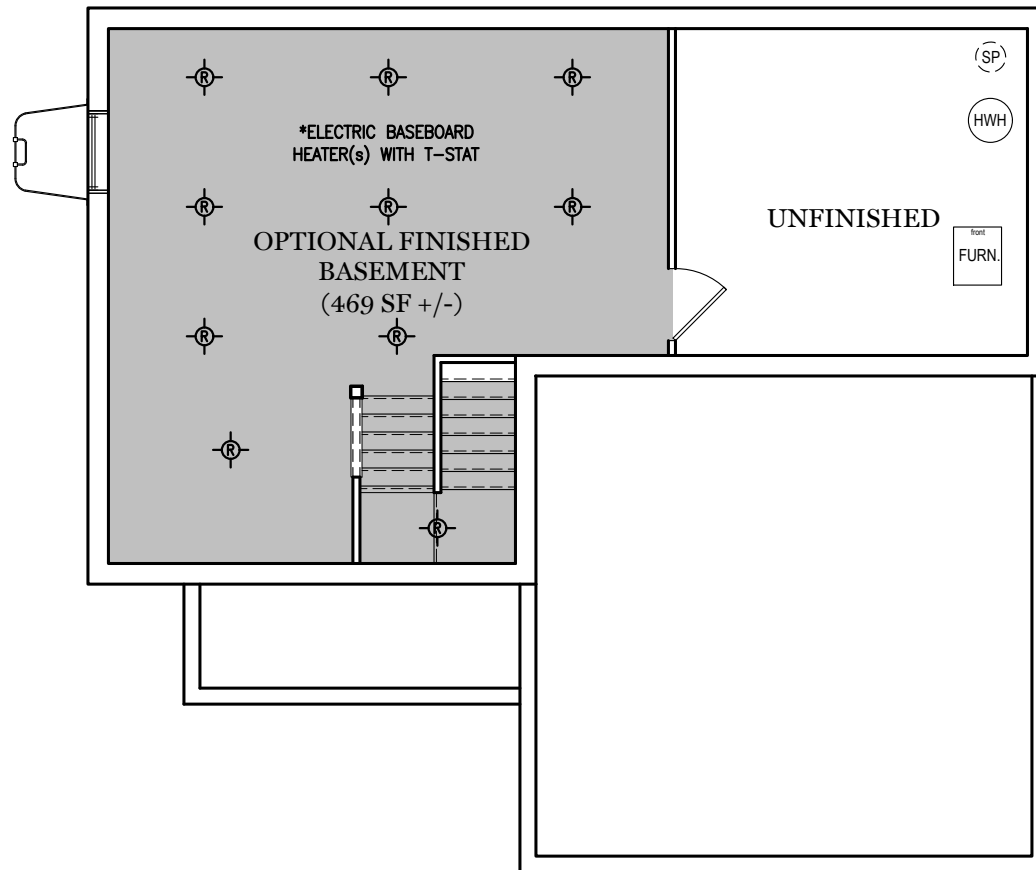

OPTIONAL FINISHED
POWDER ROOM (+36 SF)

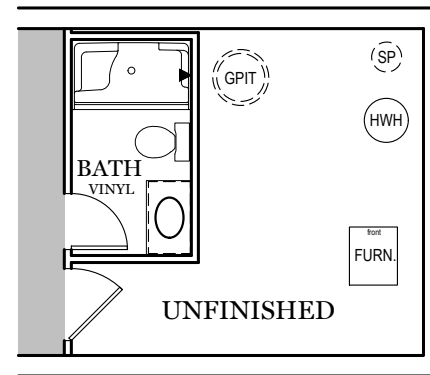

OPTIONAL FINISHED
BATHROOM (+51 SF)

ALL IMAGES ARE FOR ARTISTIC
PURPOSES ONLY AND MAY CONTAIN
ADDITIONAL FEATURES OR DESIGN
OPTIONS NOT AVAILABLE ON ALL
HOME PLANS AND IN ALL
NEIGHBORHOODS. ROOM SIZE
DIMENSIONS AND SQUARE FOOTAGES
ARE APPROXIMATE. CONTACT SALES
AGENT FOR MORE INFORMATION.
TERMS AND CONDITIONS APPLY.
[HTTPS://EGSTOLTZFUSHOMES.COM/
TERMS-AND-CONDITIONS/](https://EGSTOLTZFUSHOMES.COM/TERMS-AND-CONDITIONS/)



OPTIONAL EXTENDED COVERED PORCH



TRADITIONAL ELEVATION**



CLASSIC ELEVATION

Elevations

"ROCKFORD"



OPTIONAL EXTENDED COVERED PORCH



AMERICAN ELEVATION



HERITAGE ELEVATION

Elevations

"ROCKFORD"