

- = CARPETED AREA
 ⌚ = EXTERIOR RECEPTACLE
 ⌚ = CABLE T.V. OUTLET
 W/ ELECTRICAL OUTLET
 ⌚ = FLUSH MOUNT RECESSED-STYLE LIGHT
 ⌚ = CEILING LIGHT
 HB = EXTERIOR HOSE BIBB

LIME SPRING VILLAGE

MIFFLIN SEQUENCE "G"

ALL IMAGES ARE FOR ARTISTIC PURPOSES ONLY AND
 MAY CONTAIN ADDITIONAL FEATURES OR DESIGN
 OPTIONS NOT AVAILABLE ON ALL HOME PLANS AND
 IN ALL NEIGHBORHOODS. ROOM SIZE DIMENSIONS
 AND SQUARE FOOTAGES ARE APPROXIMATE.
 CONTACT SALES AGENT FOR MORE INFORMATION.
 TERMS AND CONDITIONS APPLY.
[HTTPS://EGSTOLTZFUSHOMES.COM/
 TERMS-AND-CONDITIONS/](https://egstoltzfushomes.com/terms-and-conditions/)

PDF LAST UPDATED 05/26/2023

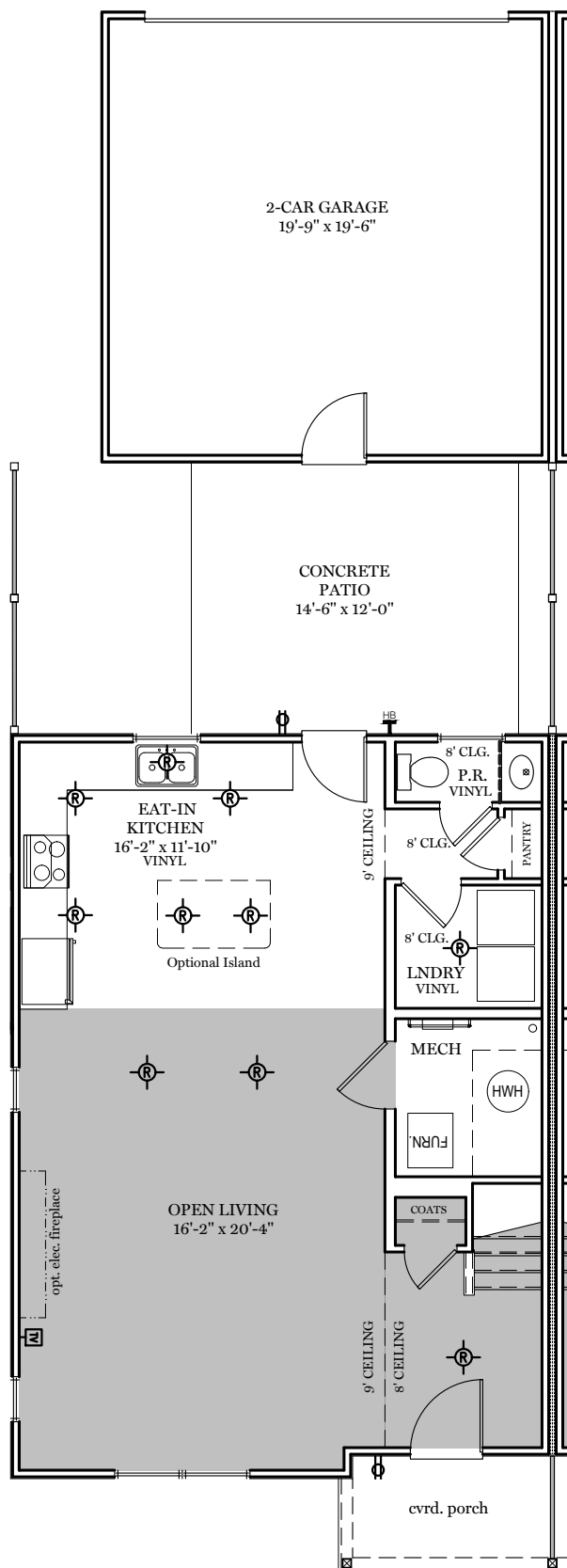

Living Floor Plan - 783 sf

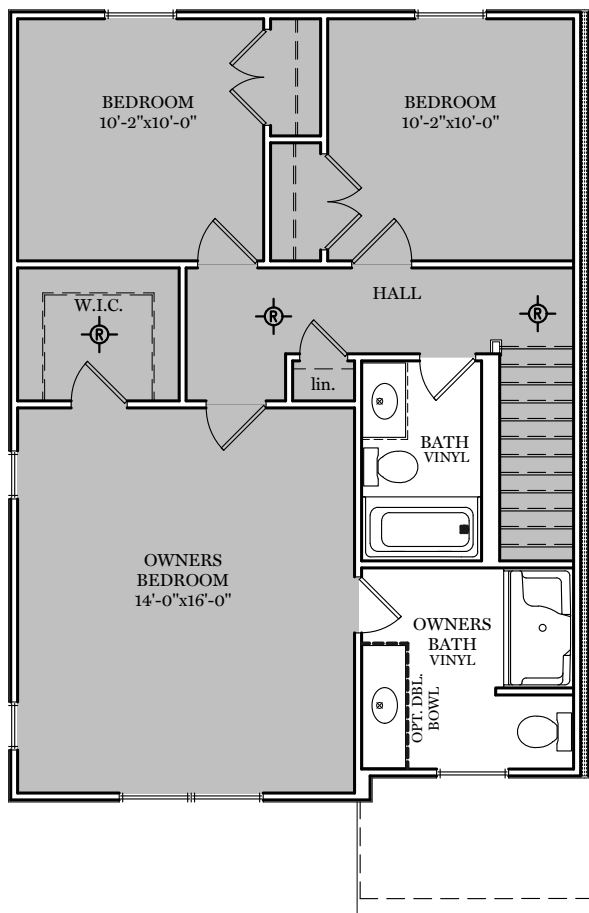

Upper Floor Plan - 783 sf

- = CARPETED AREA
 ⌚ = EXTERIOR RECEPTACLE
 □ = CABLE T.V. OUTLET
 W/ ELECTRICAL OUTLET
 Ⓡ = FLUSH MOUNT RECESSED-STYLE LIGHT
 ○ = CEILING LIGHT
 HB = EXTERIOR HOSE BIBB

LIME SPRING VILLAGE

MIFFLIN SEQUENCE "H"

ALL IMAGES ARE FOR ARTISTIC PURPOSES ONLY AND
 MAY CONTAIN ADDITIONAL FEATURES OR DESIGN
 OPTIONS NOT AVAILABLE ON ALL HOME PLANS AND
 IN ALL NEIGHBORHOODS. ROOM SIZE DIMENSIONS
 AND SQUARE FOOTAGES ARE APPROXIMATE.
 CONTACT SALES AGENT FOR MORE INFORMATION.
 TERMS AND CONDITIONS APPLY.
[HTTPS://EGSTOLTZFUSHOMES.COM/
 TERMS-AND-CONDITIONS/](https://egstoltzfushomes.com/terms-and-conditions/)



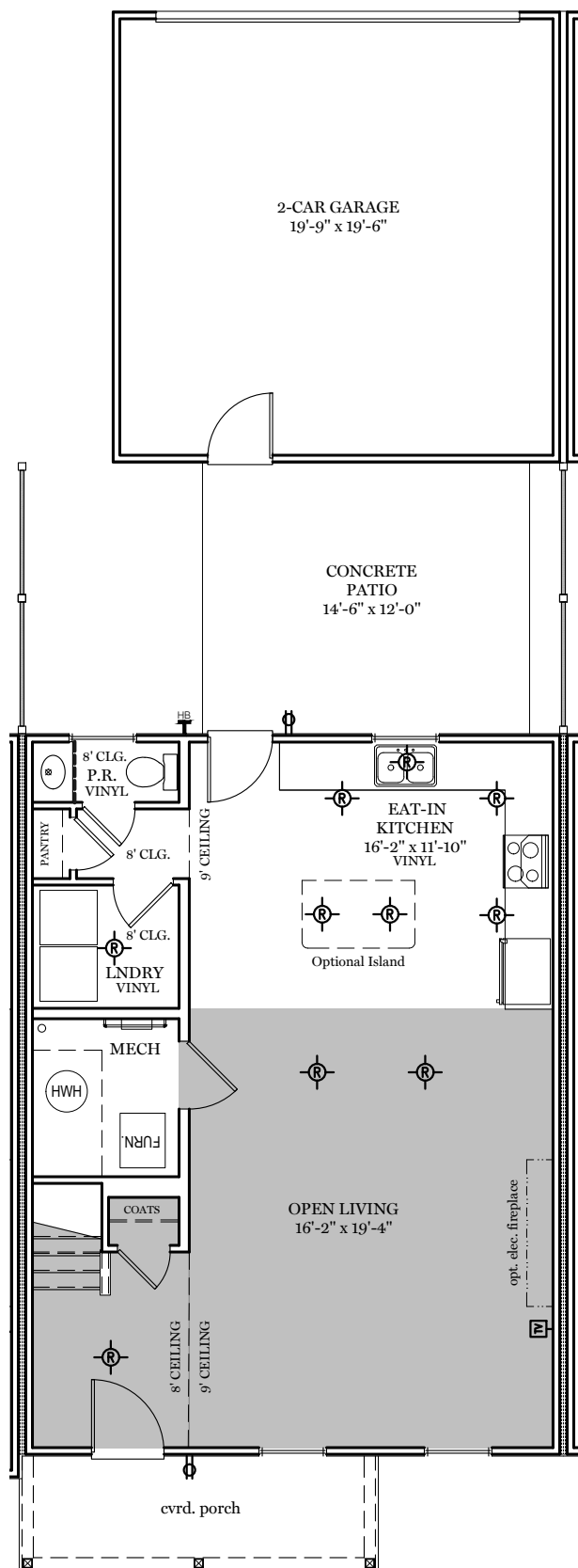

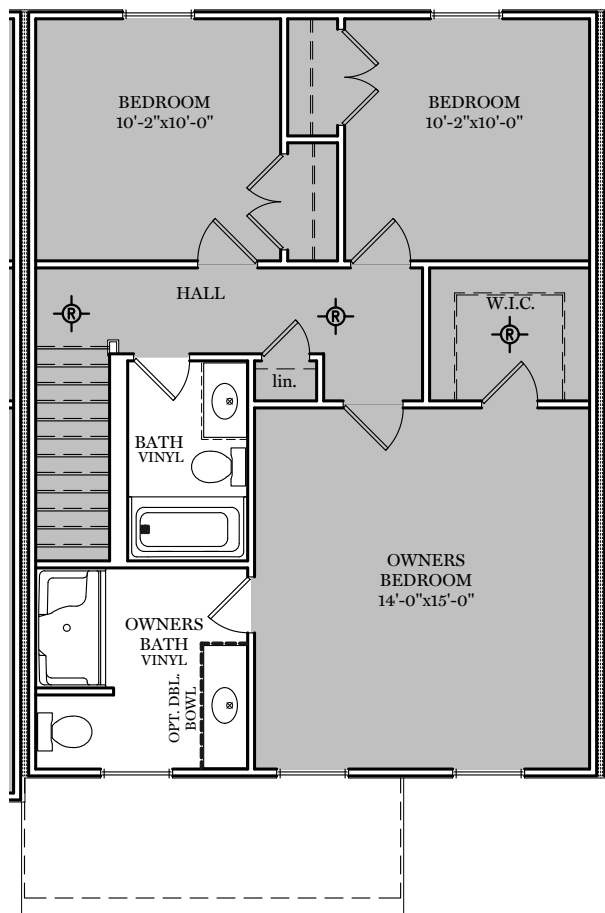

PDF LAST UPDATED 05/26/2023



Living Floor Plan - 768 sf

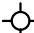

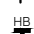
Upper Floor Plan - 768 sf

-  = CARPETED AREA
-  = FLUSH MOUNT RECESSED-STYLE LIGHT
-  = EXTERIOR RECEPTACLE
-  = CEILING LIGHT
-  = CABLE T.V. OUTLET
-  = EXTERIOR HOSE BIBB
-  W/ ELECTRICAL OUTLET

LIME SPRING VILLAGE

MIFFLIN SEQUENCE "I"

ALL IMAGES ARE FOR ARTISTIC PURPOSES ONLY AND MAY CONTAIN ADDITIONAL FEATURES OR DESIGN OPTIONS NOT AVAILABLE ON ALL HOME PLANS AND IN ALL NEIGHBORHOODS. ROOM SIZE DIMENSIONS AND SQUARE FOOTAGES ARE APPROXIMATE. CONTACT SALES AGENT FOR MORE INFORMATION. TERMS AND CONDITIONS APPLY.
[HTTPS://EGSTOLTZFUSHOMES.COM/TERMS-AND-CONDITIONS/](https://egstoltzfushomes.com/terms-and-conditions/)

PDF LAST UPDATED 05/26/2023

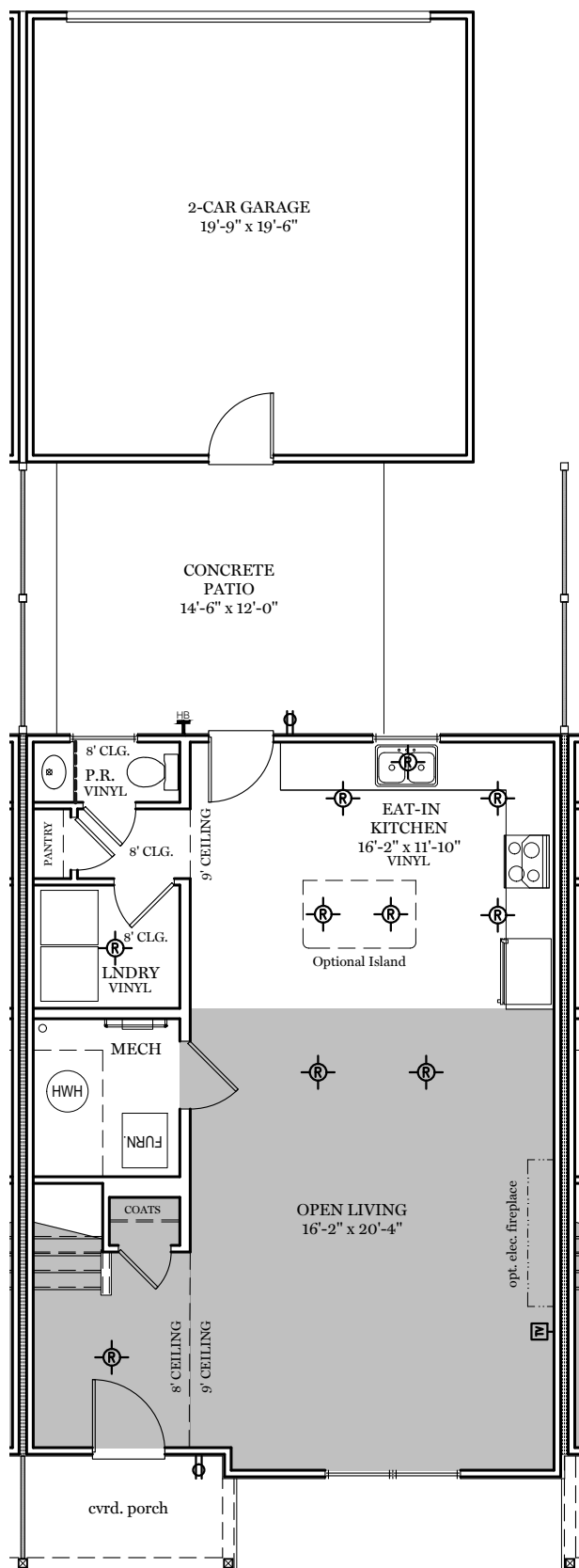

Living Floor Plan - 783 sf

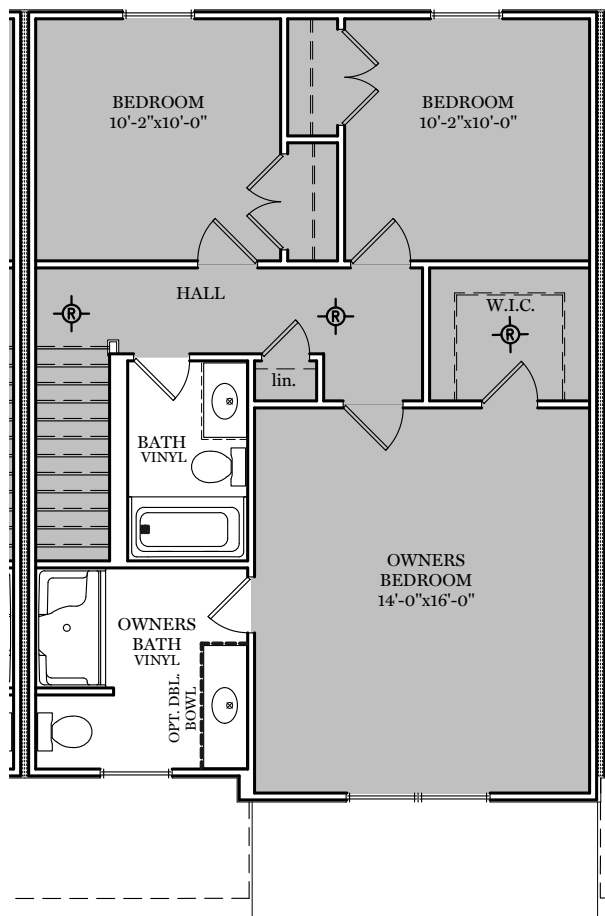

Upper Floor Plan - 783 sf